

VS COR® Spin 800

Lagerkreuz
Bearing cross
Typ A

MONTAGEANLEITUNG / ASSEMBLY MANUAL

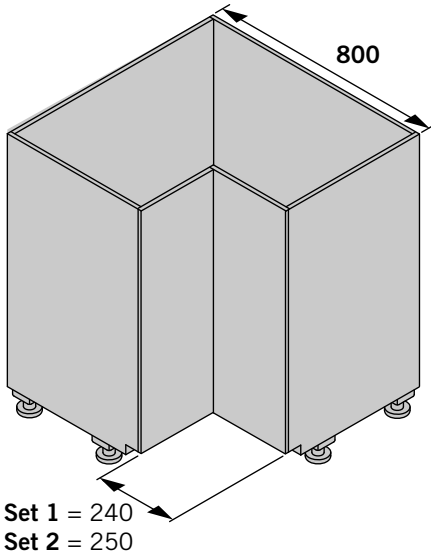

Set	S	A	B	C	TS	D	E	F
Set 1	16	240	500	740-S	16-22	2-4	230	236-TS-D
	18							
	19							
Set 2	16	250	510	760-S	16-22	2-4	240	246-TS-D
	18							
	19							

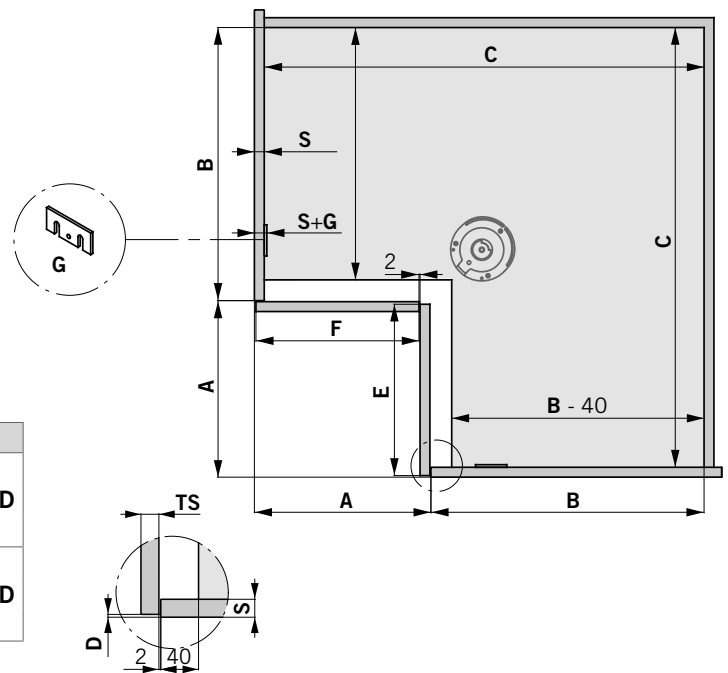

1

	Set 1			Set 2		
S	16	18	19	16	18	19
X	363	361	360	373	371	370

3.5 x 25

2

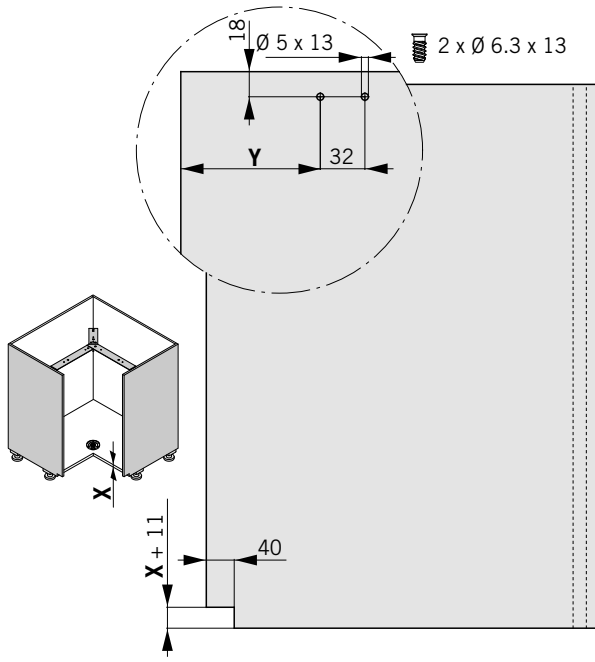

	Set 1	Set 2
Y	100	90

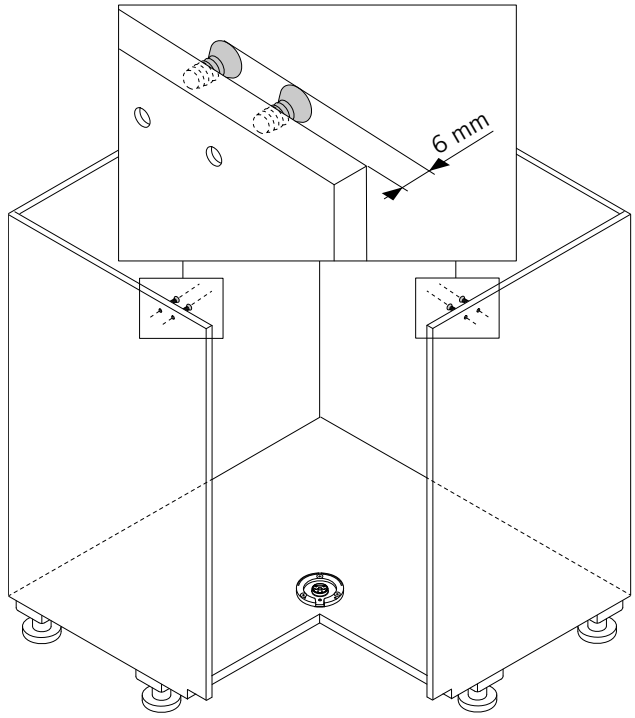

3

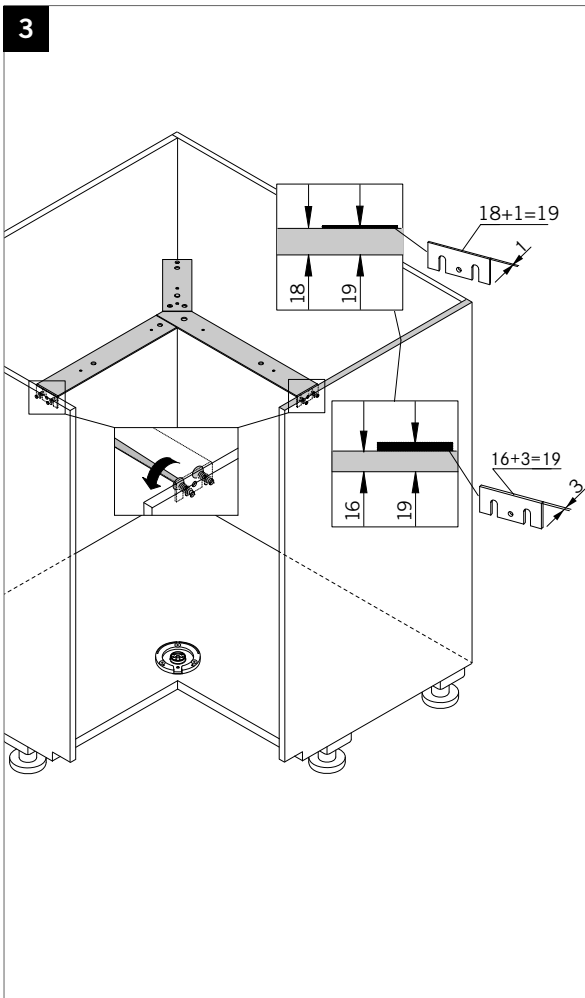

4

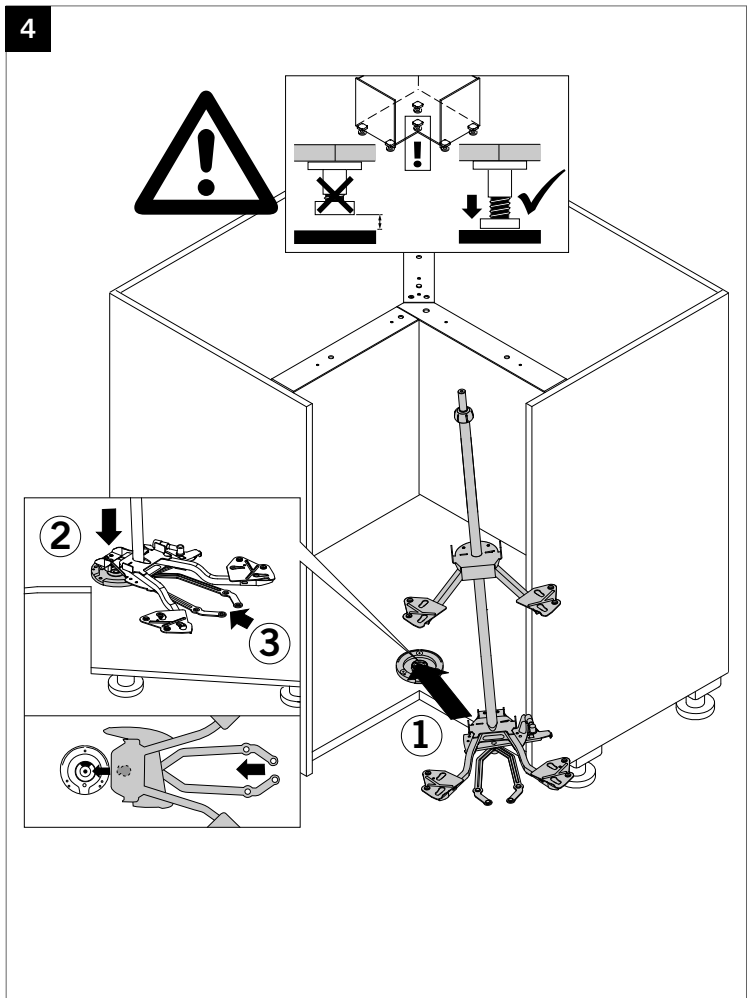

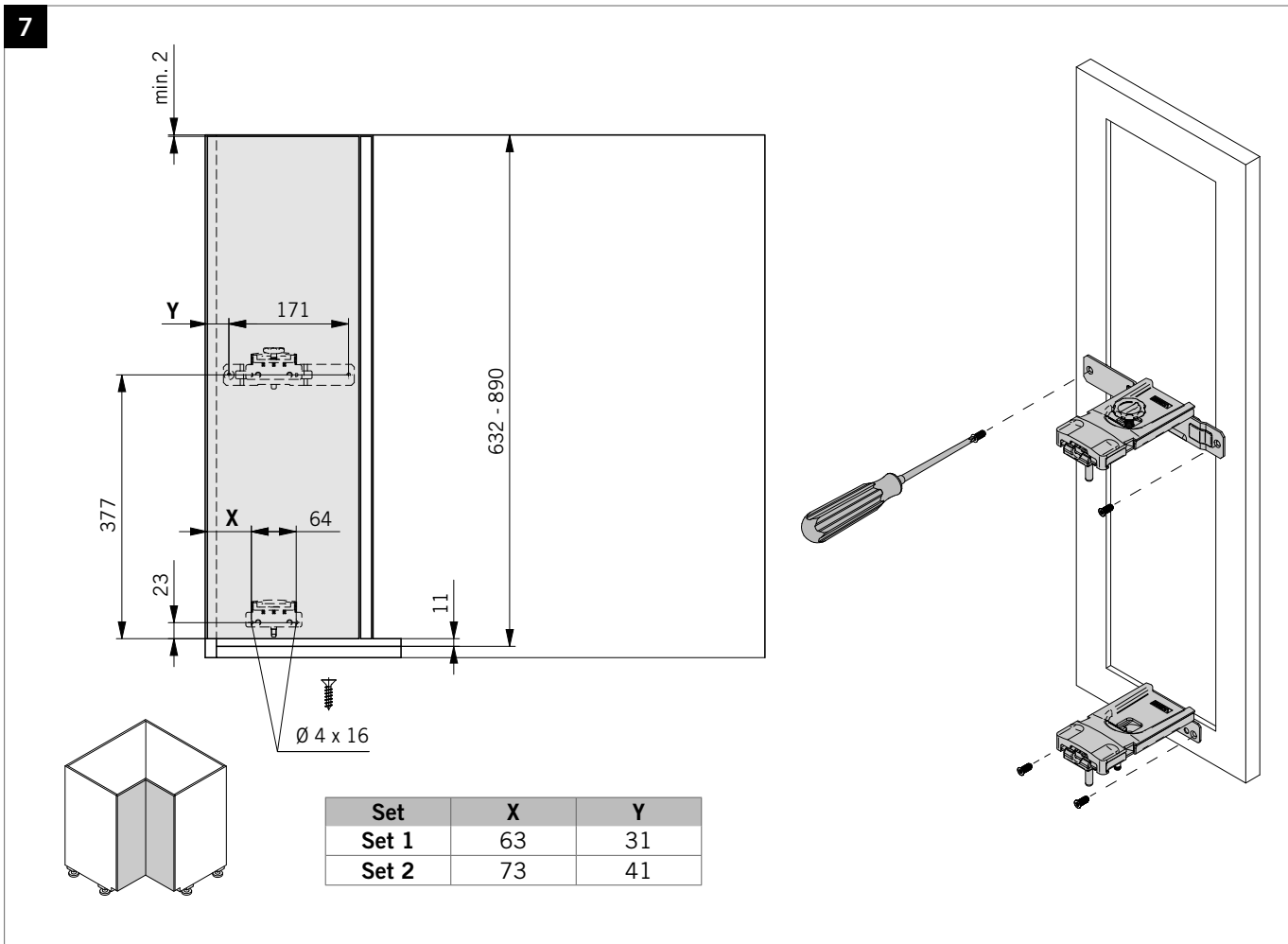
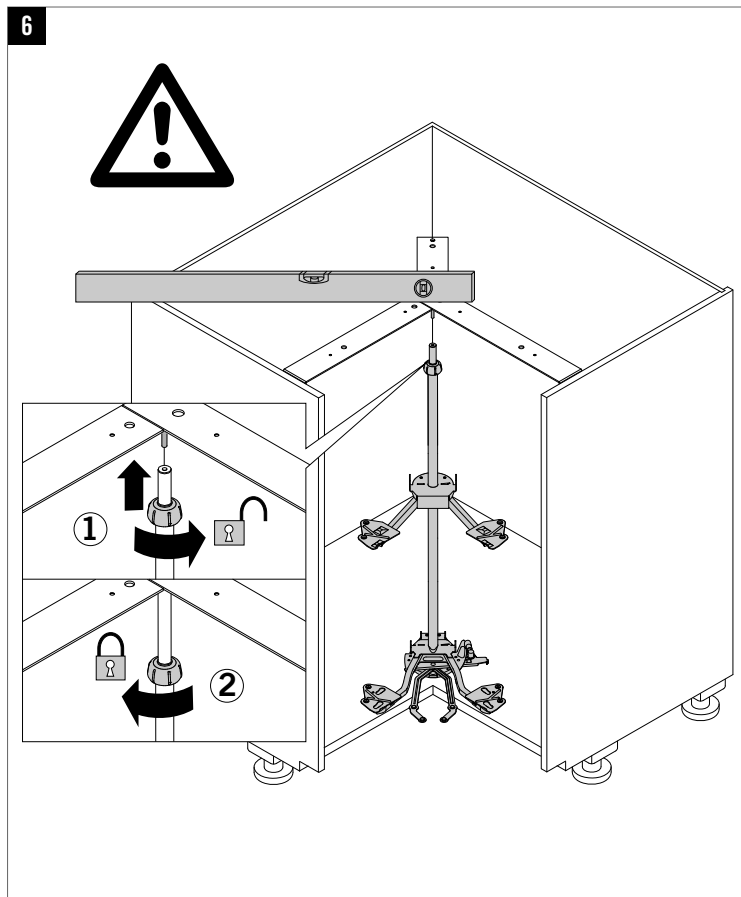
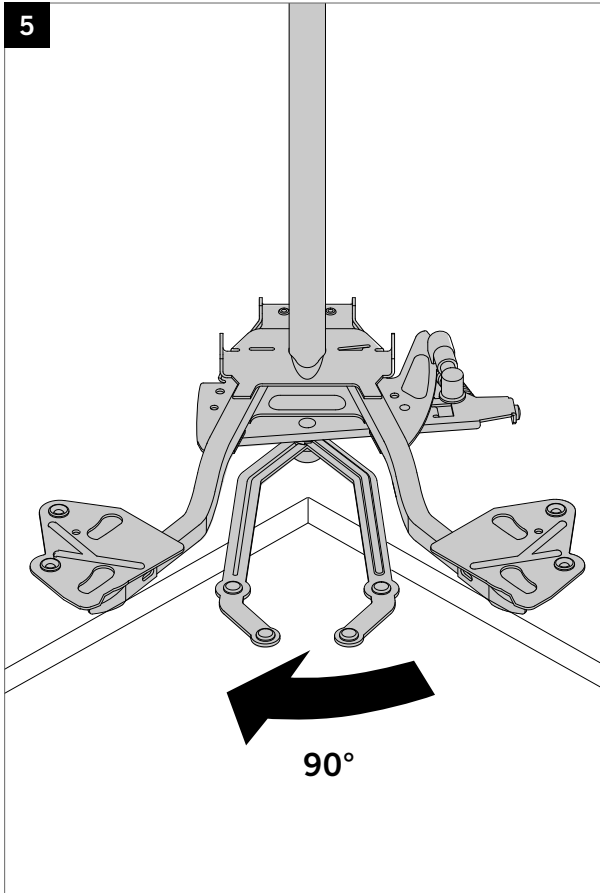

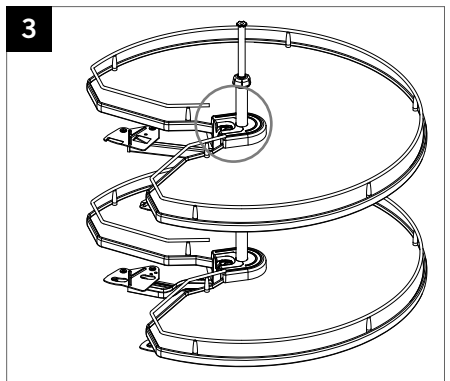
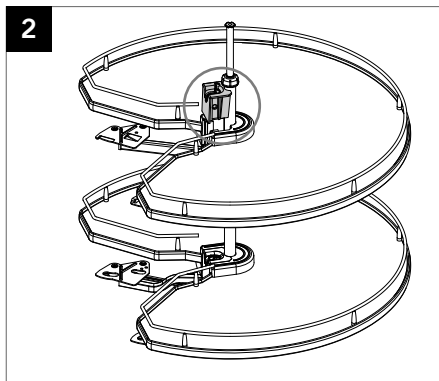
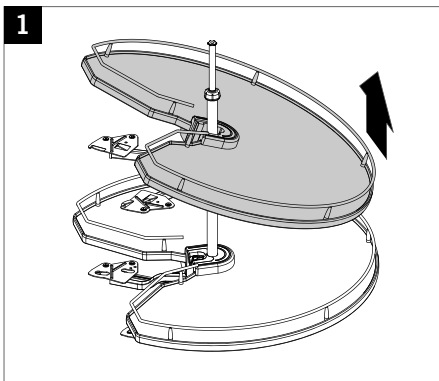
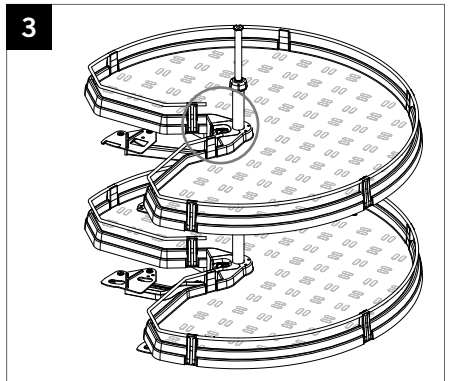
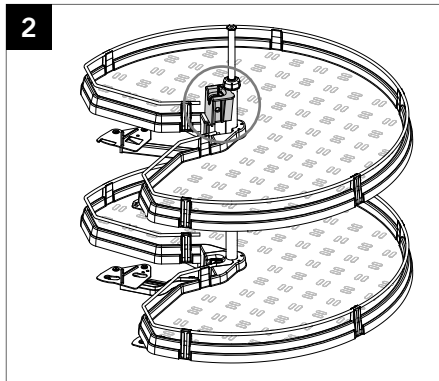
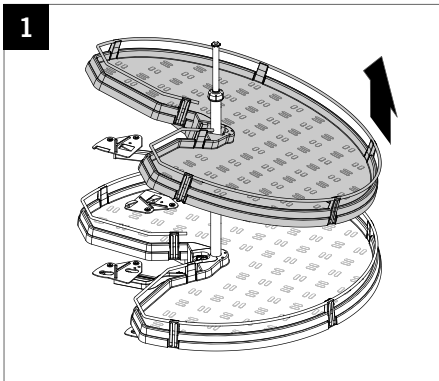
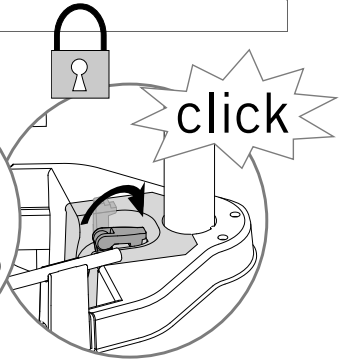
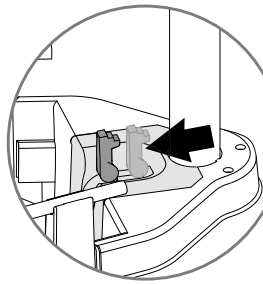
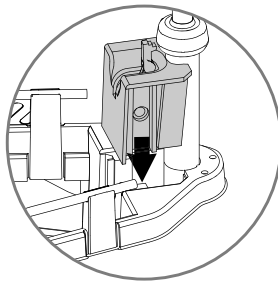
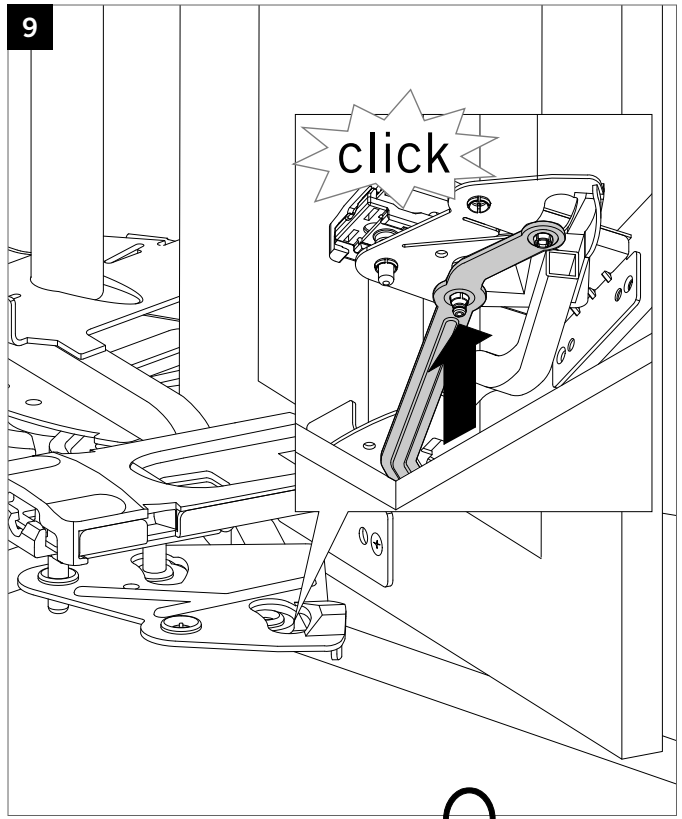
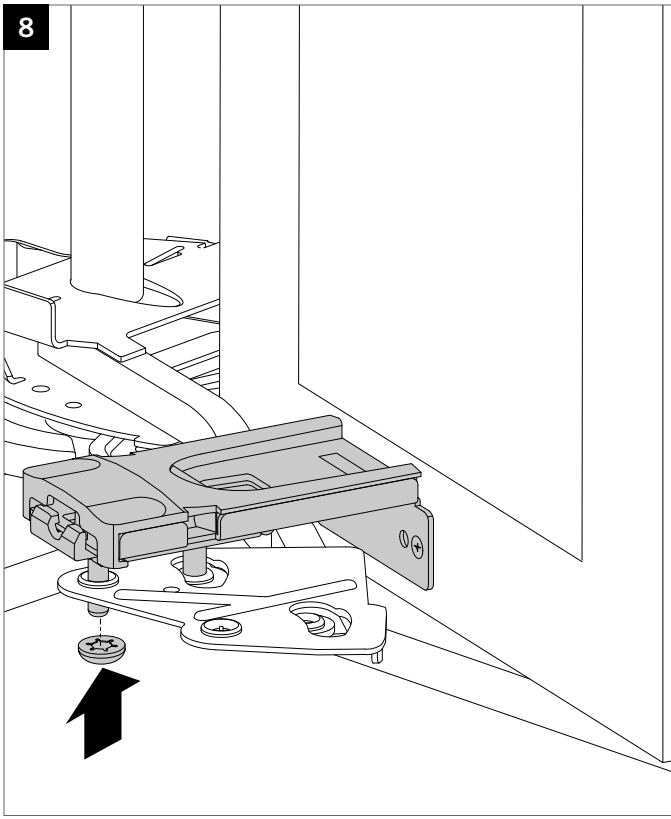

Verstellmöglichkeiten / Adjustment of the doors and shelf

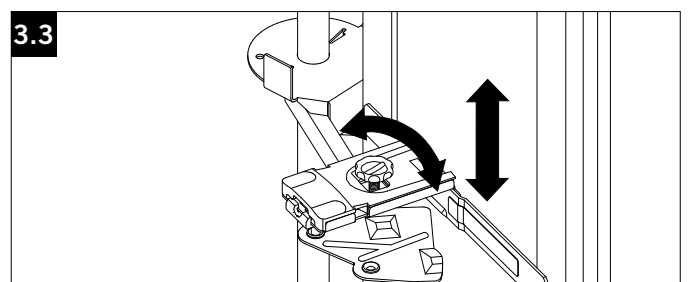
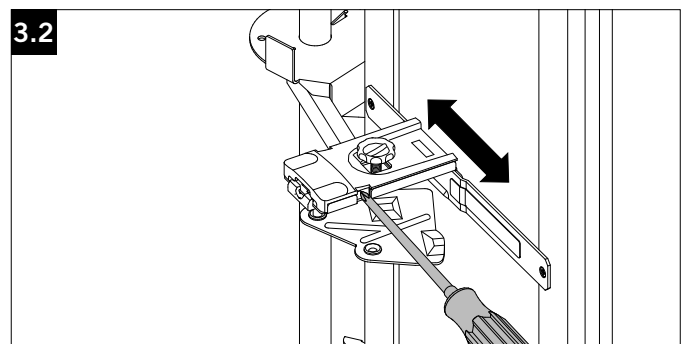
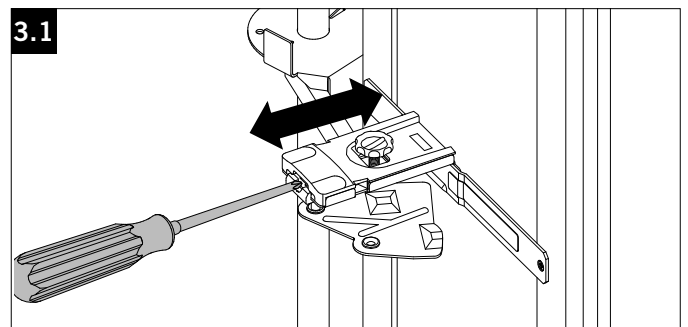
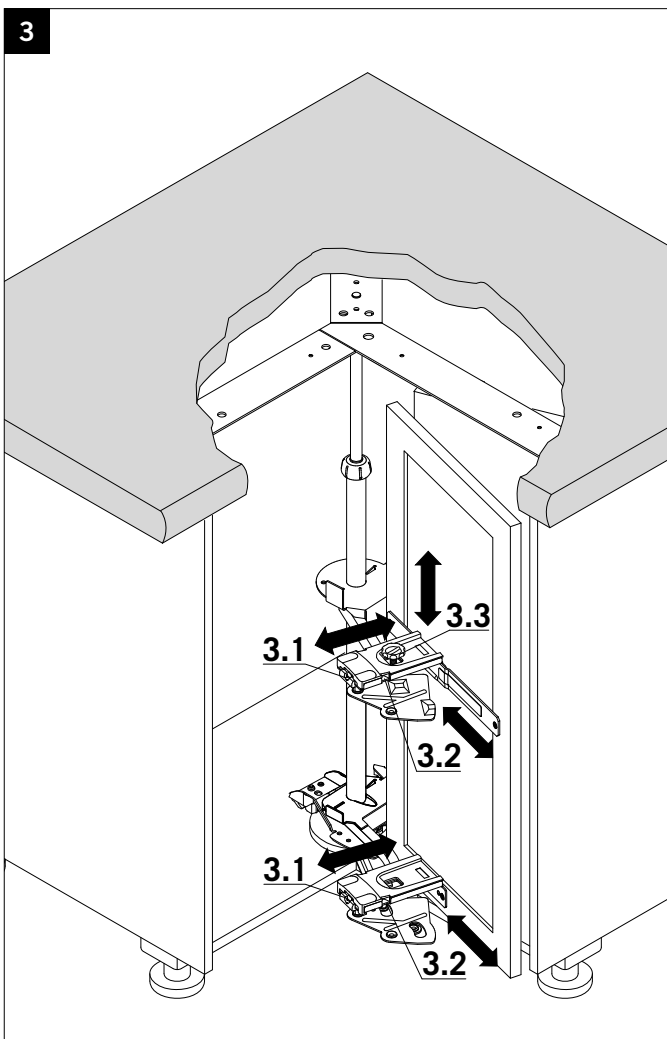
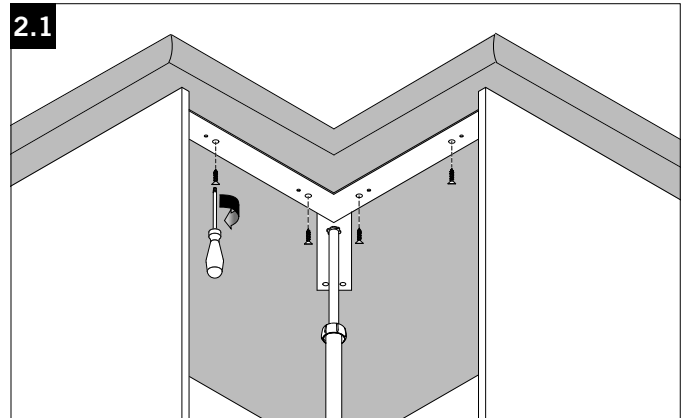
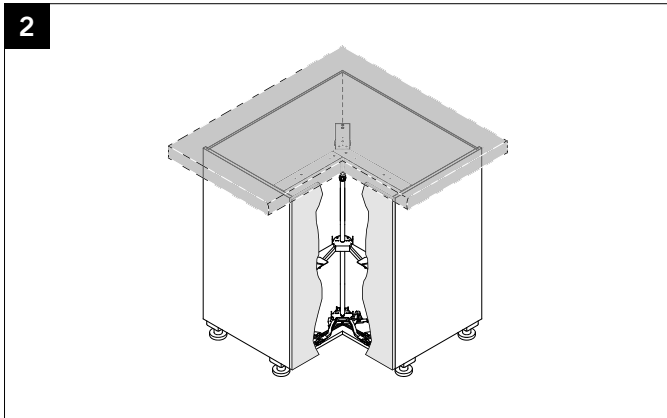
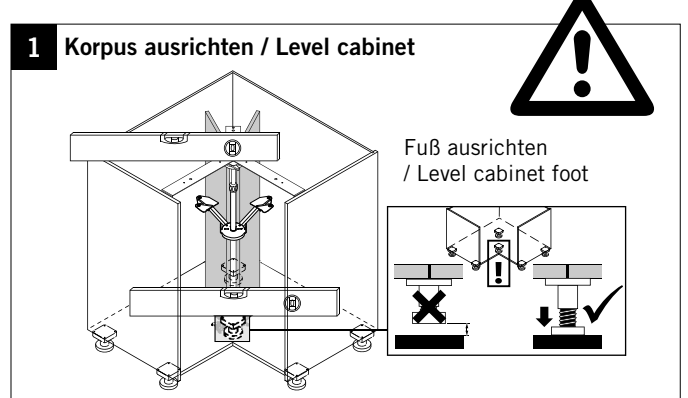
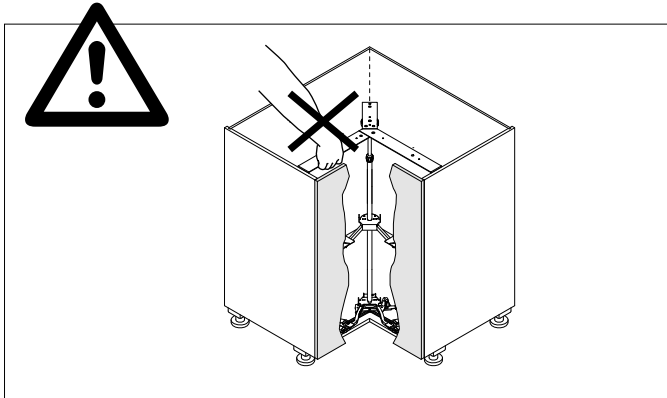

Einstellen der Dämpfung / Damping adjustment

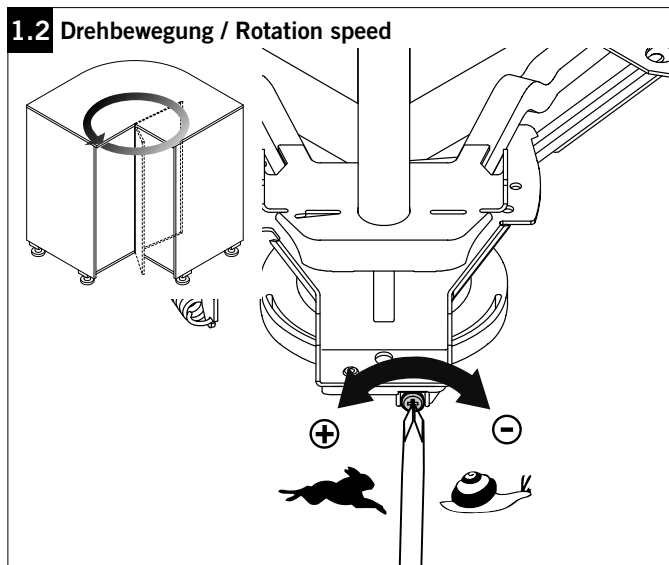
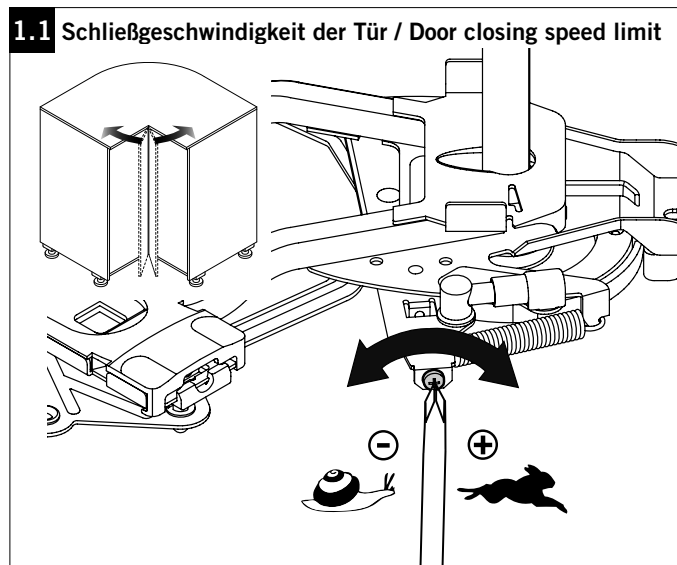
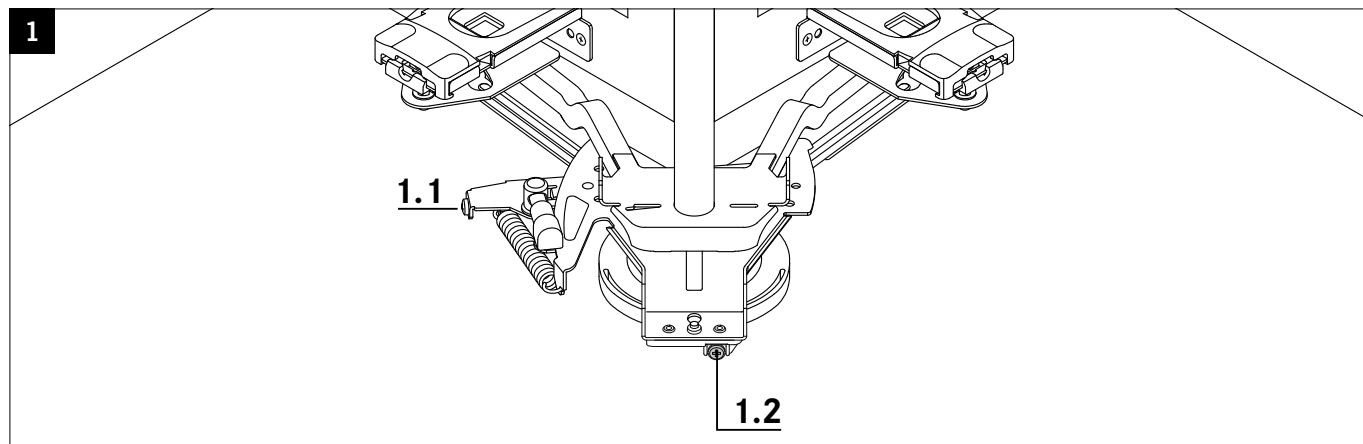

Wartungshinweis / Maintenance note

